

FILTRI ATTIVI: M1 • GS

[<<](#) n. 2/2 [>>](#)
 sottogruppo: 41201/00 - COMANDO STERZO (Tav:2/2)
 validità: Sempre valido

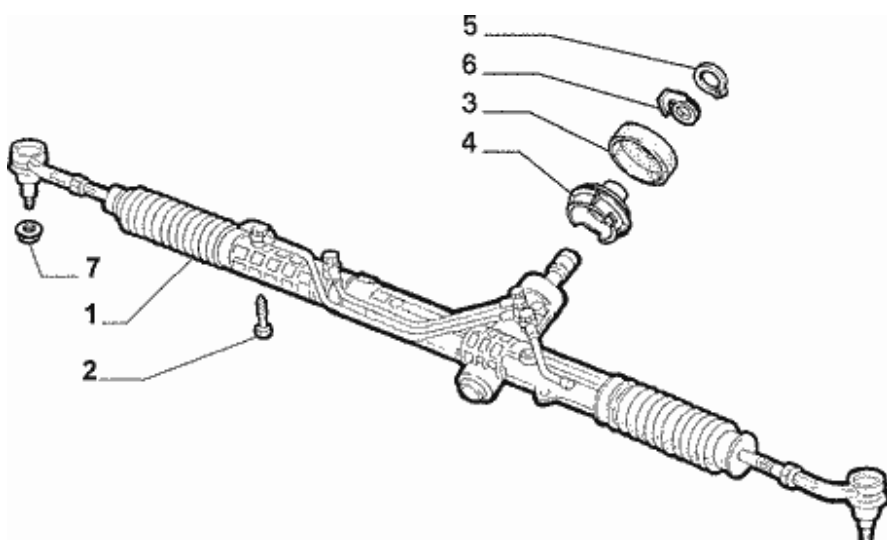

COD. PROD.	D. VALIDITA'	M. Q.TÀ	N. C. C.	RICONDIZ. (CARCASSA)
1 SERVOSTERZO				
<input checked="" type="checkbox"/> 60653055	GS +M1	01		71783208 <input type="checkbox"/>
<input type="checkbox"/> 60653055	GS +M2	01		71722525 <input type="checkbox"/>
<input type="checkbox"/> 60653057	GD +M2	01		71783208 <input type="checkbox"/>
<input type="checkbox"/> 60653057	GD +M2	01		71722525 <input type="checkbox"/>
<input type="checkbox"/> 60670085	GS +83	01		71783214 <input type="checkbox"/>
<input type="checkbox"/> 60670085	GS (M3 ,M5)	01		71722529 <input type="checkbox"/>
<input type="checkbox"/> 60670085	GS (M3 ,M5)	01		71722524 <input type="checkbox"/>
<input type="checkbox"/> 60670087	GD +M4	01		71722525 <input type="checkbox"/>
<input type="checkbox"/> 60670087	GD +M4	01		71722528 <input type="checkbox"/>
<input type="checkbox"/> 60677748	GS +M4	01		71722529 <input type="checkbox"/>
<input type="checkbox"/> 60677748	GS +M4	01		71783202 <input type="checkbox"/>
<input type="checkbox"/> 60677748	GS +M4	01		71722523 <input type="checkbox"/>
2 VITE				
<input type="checkbox"/> 60625932		02		
3 TAMPONE				
<input type="checkbox"/> 46804417		01		
4 SCODELLINO				
<input type="checkbox"/> 60625920		01		
5 ANELLO RITEGNO				
<input type="checkbox"/> 82437724		01		
6 ANELLO SICUREZZA				
<input type="checkbox"/> 60661487		01		
7 DADO				
<input type="checkbox"/> 15505821		02		

Aggiungi al carrello >>

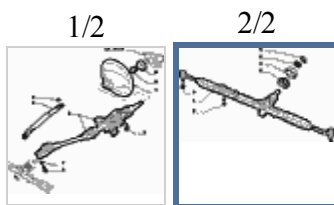

n. 2/2 : 41201/00 - COMANDO STERZO