

# ALFA-17

(ALFAROMEIO)

- MODEL : ALFA-17
- DATE : 2017.12.22

# Contents

1. Specification
2. External Appearance
3. Connector Pin Assignment
4. DIP S/W Information
5. Components
6. Connect CAN/Power diagram
7. Connect CAN/Power connector
8. OEM Buttons usage
9. DVB-T Connection Diagram for AV Input
10. PDC Function
11. Screen Ratio
12. Screen PDC Mode
13. IR icon Control
14. Remote control setting
15. Switch function

# 1

## Specification

- **Interface**
  1. **Input Spec.**
    - A/V \*2
    - CVBS(Front camera) \*1
    - CVBS(Rear camera) \*1
    - Dip Switch 10P
    - LVDS Input
  2. **Output Spec.**
    - Audio L/R Output \*1
    - LVDS Output \*1
    - RGB Output \*1
    - IR Output \*1
  3. **Power Spec.**
    - Input Power : 12V DC ~ 24V DC
    - Consumption Power : 12 Watt Max
    - Operating Temperature :-15°C ~ +70°C
  4. **I/O**
    - **Output**
      1. 12V Output ( 3A Max )
      2. DVB-T IR ( Remote Control )



## 2

## External Appearance

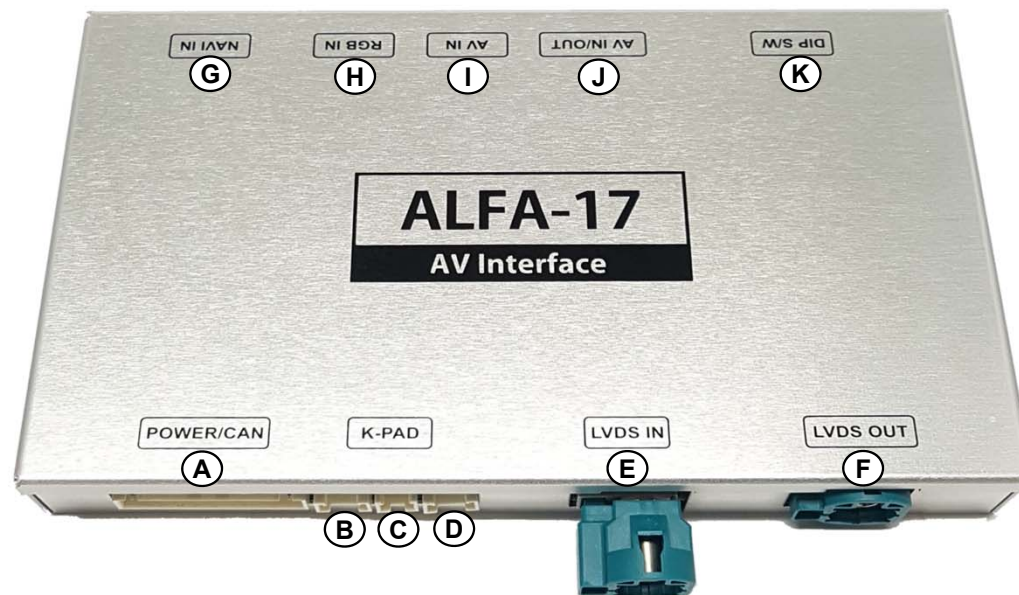

A	Power/Can connector	G	NAVI Input
B	DEBUG - main	H	RGB Output
C	K-PAD	I	AV connector
D	DEBUG - tw88	J	Universal connector
E	LVDS-IN	K	Dip Switch
F	LVDS-OUT		

# 3

## Connector Pin Assignment



or



※ POWER CABLE

※ UNIVERSAL CABLE

※ AV CABLE

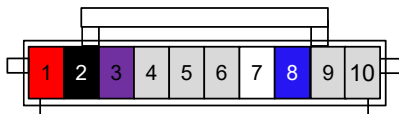

1	ACC IN	2	GND
3	12V_OUT	4	N.C.
5	N.C.	6	N.C.
7	CAN_IN_H	8	CAN_IN_L
9	N.C.	10	N.C.

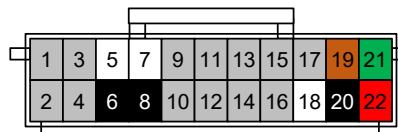

1	N.C.	2	N.C.
3	N.C.	4	N.C.
5	AUX_OUT_R	6	AUX_GND
7	AUX_OUT_L	8	AUX_GND
9	N.C.	10	N.C.
11	N.C.	12	N.C.
13	N.C.	14	N.C.
15	N.C.	16	N.C.
17	N.C.	18	IR_IN
19	DVB-T_IR	20	IR_GND
21	DVD_IR	22	IR_POWER

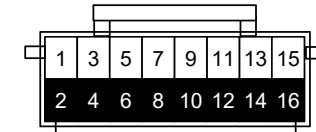

1	DVBT_IN_V	2	GND
3	DVBT_IN_R	4	GND
5	DVBT_IN_L	6	GND
7	DVD_IN_V	8	GND
9	DVD_IN_R	10	GND
11	DVD_IN_L	12	GND
13	FRONT_IN	14	GND
15	REAR_IN	16	GND

## 4

## DIP S/W Information

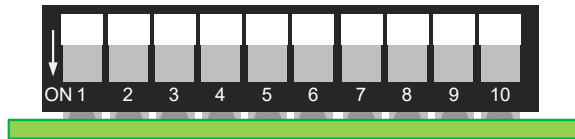

Pin No.	ON	OFF
1	DVBT Mode	Skip DVBT Mode
2	DVD Mode	Skip DVD Mode
3	External Front View Camera	Skip External Front View Camera
4	External Rear View Camera	Original Rear View Camera

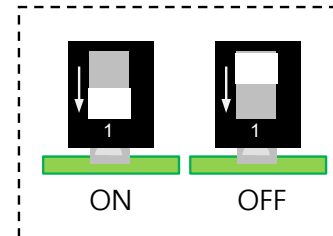

No. 6	No. 7	No. 8	No. 9	No. 10	Car Model
OFF	OFF	OFF	OFF	OFF	ALFAROMEO GIULIA 2017

# 5

## Components



**ALFA-17**



**Power/ CAN Cable**

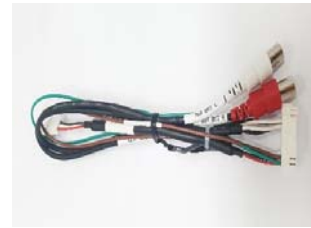

**Universal Cable**

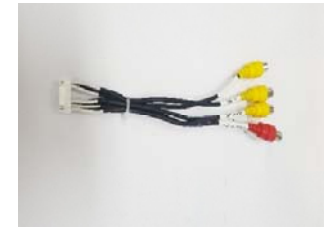

**AV Cable**



**LVDS In/Out Cable**



**Key Pad**



**Tact Switch**

## 6

## Connect CAN/Power Diagram

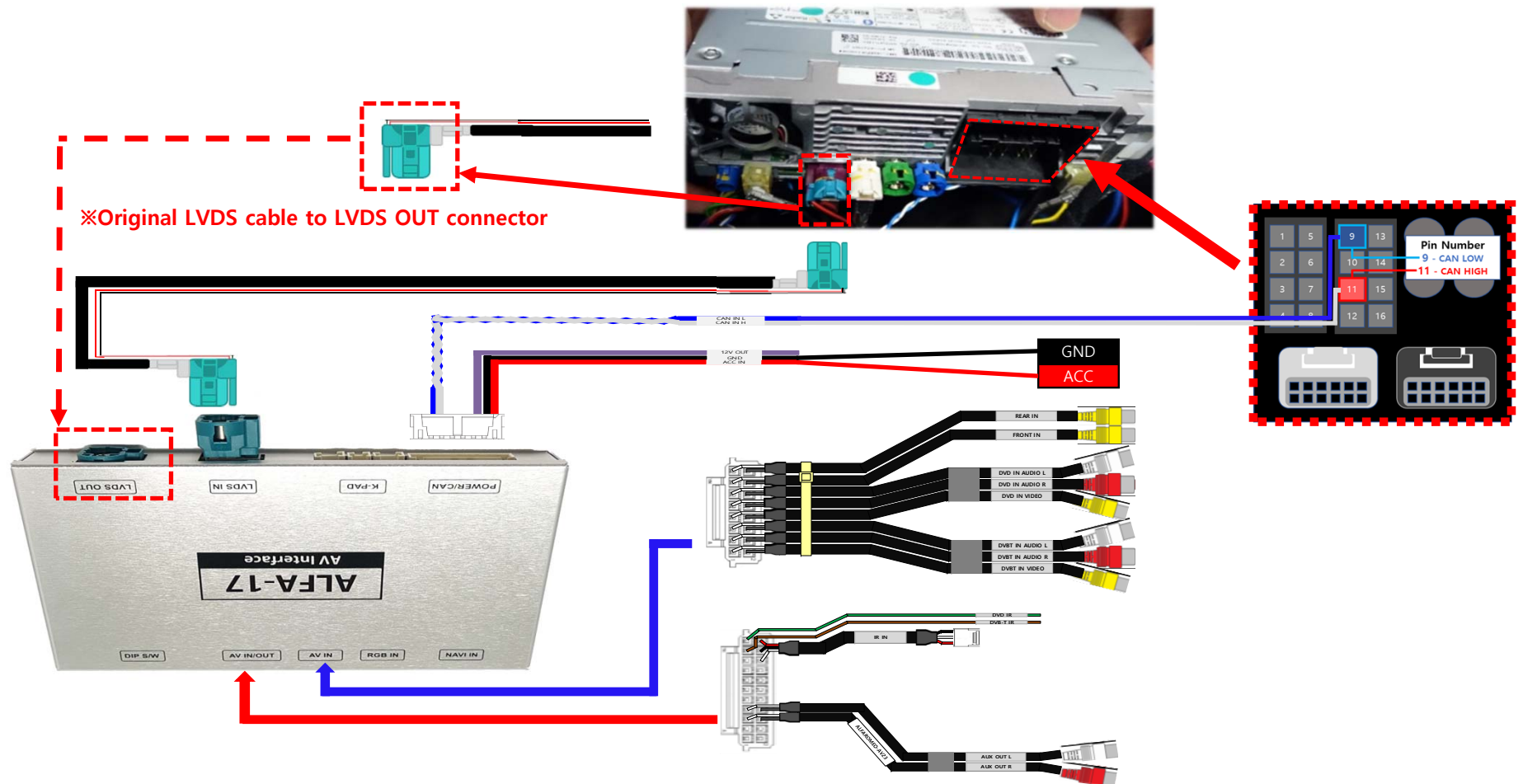



# 7

## Connect CAN/Power connector

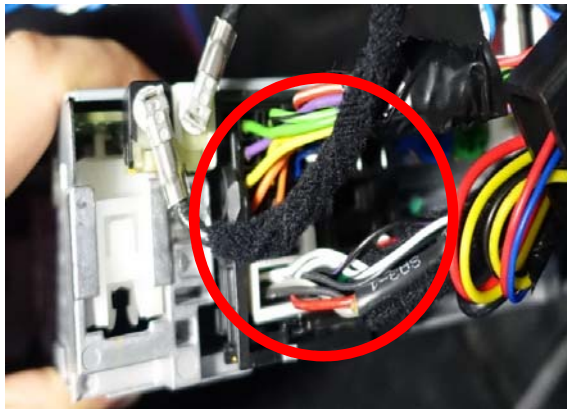

- Remove original connector.

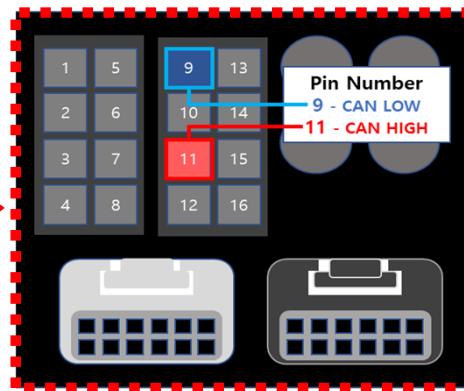
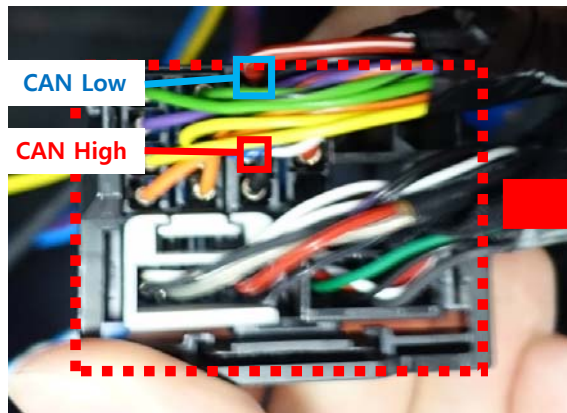

- "CAN High/Low" Cable to the original connector

## 8

## OEM Buttons usage

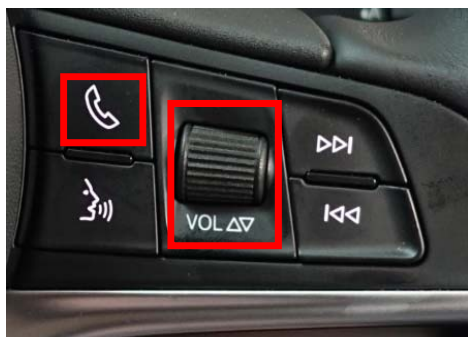

no	Button	Press	Mode	Function
1	MUTE	Long Press (2sec)	OEM	DVBT-DVD-OEM-DVBT
2	PHONE	Short Press	OEM	To Oem Screen



Button	Press	Mode	Function
MENU	Long Press (1sec)	OEM	DVBT-DVD-OEM-DVBT
	Short Press (one)	OEM	OEM
	Short Press(two)	OEM	FRONT
	Short Press(three)	OEM	DVD
	Long Press (5sec)	OEM	QUICK INFO
OPTION	Long Press (3sec)	OEM	Screen Ratio(FULL - 4:3 - interface:oem)

# 9

## DVB-T Connection Diagram for AV Input

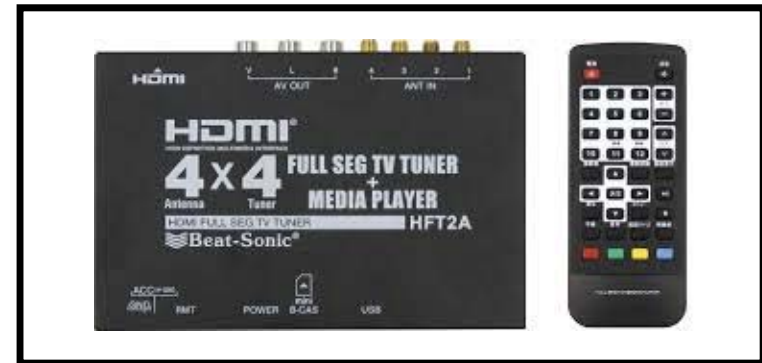
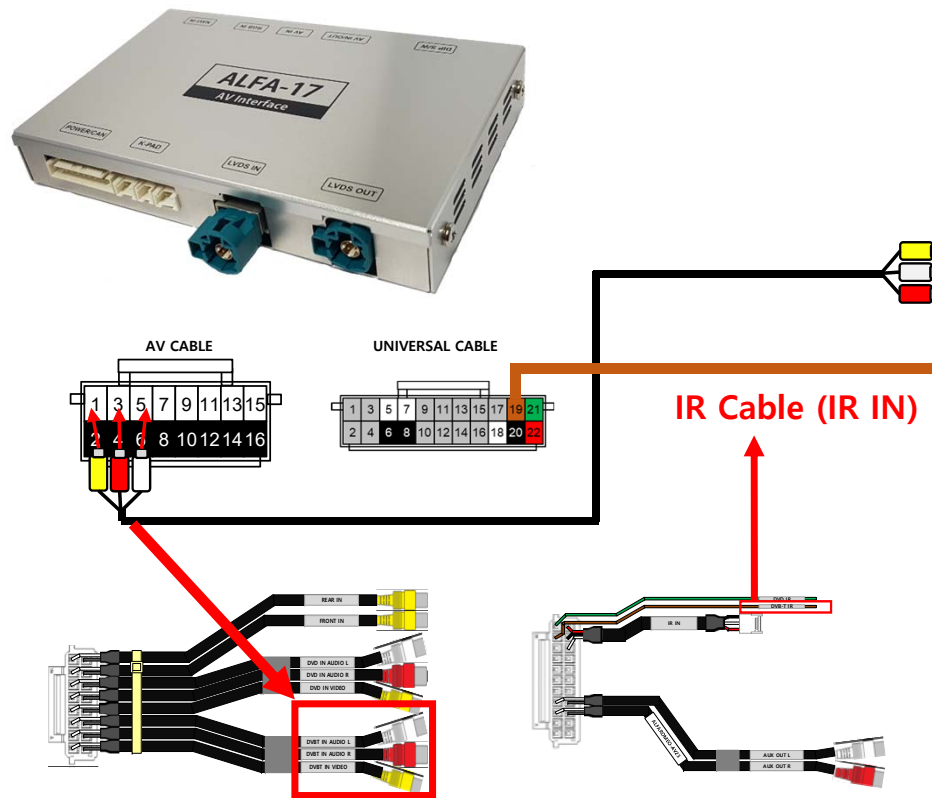

HFT2A



GEX 909DTV

# 10

## PDC Function



press the MENU button,  
the screen can be adjusted in 3steps.



OEM

Menu Button  
once push



DVD

Menu Button  
twice push



X2



Front screen

Menu Button  
thrice push



X3

※ Press menu button to switch screen

# 11

## Screen Ratio



press the option button long(3sec),  
the screen can be adjusted in 3steps.



**Full screen**



**4 : 3 Ratio**

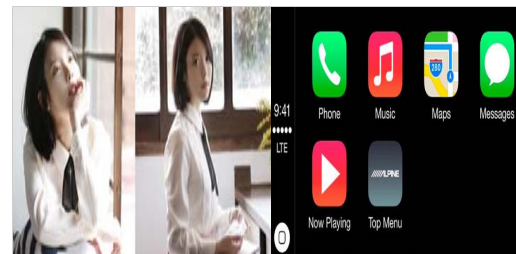

**5 : 5 Mode**

(interface screen and original screen)



# 12

## Screen PDC Mode



Car PDC on / off button



Full screen



4:3 Ratio

※PDC pop-up occurs PDC events in the screen occur.



Interface screen.



Original screen.



Original screen.



Interface screen.

Call a cell phone connected with Bluetooth, it changes to the original screen.  
Return to the original screen after the call end.

# 13

## IR icon Control



IR icon is not displayed, but it is possible to move up and down.

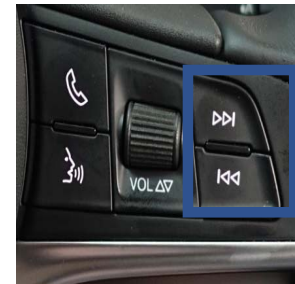

SEEK



I-Driver wheel



IR-icon is displayed, select it and click it, the operation.

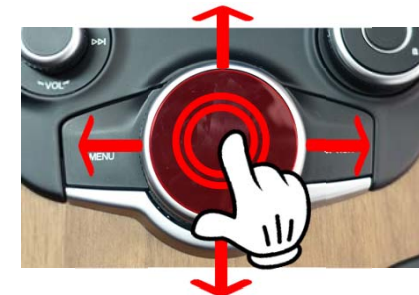

I-Driver wheel

# 14

## Remote control setting

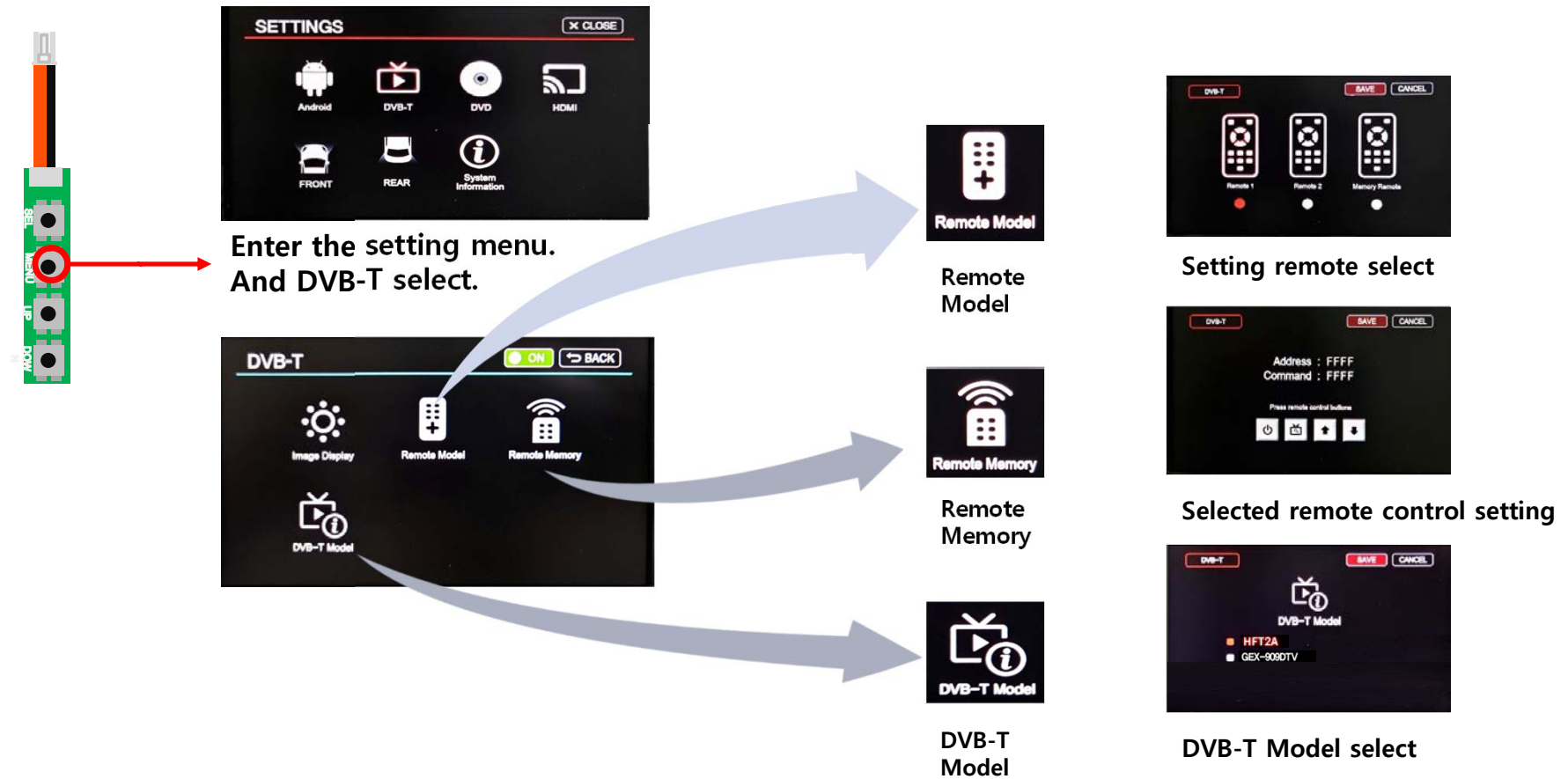



# 15

## Switch function

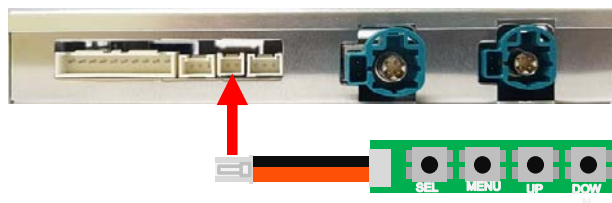

Key	Function
Sel	Select setting menu
Menu	Enter the setting menu
Up	Moving Up
Down	Moving Down

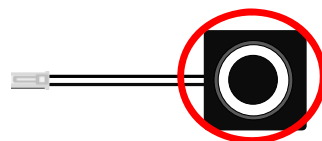
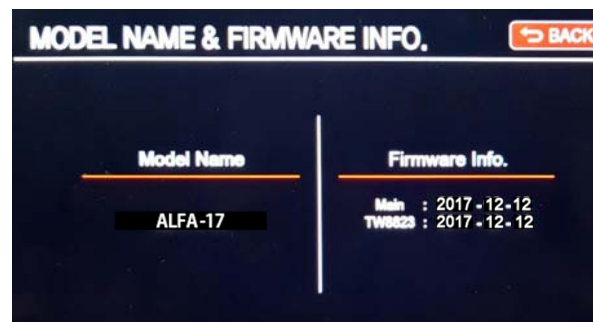
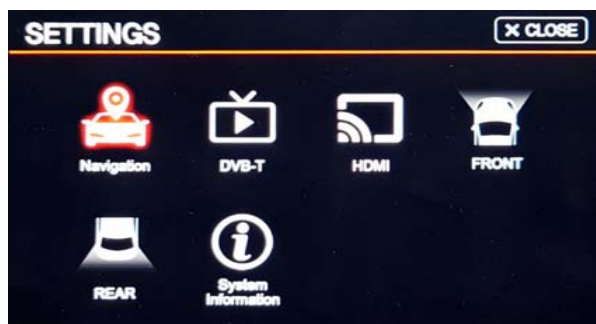

Tact SW

or



Key SW

no	Button	Press	Mode	Function
1	Tact SW	Short Press	OEM	DVBT-DVD-OEM-DVBT
2	MENU	Short Press	OEM	DVBT-DVD-OEM-DVBT